

# Microvette® 100/200

## User Guide

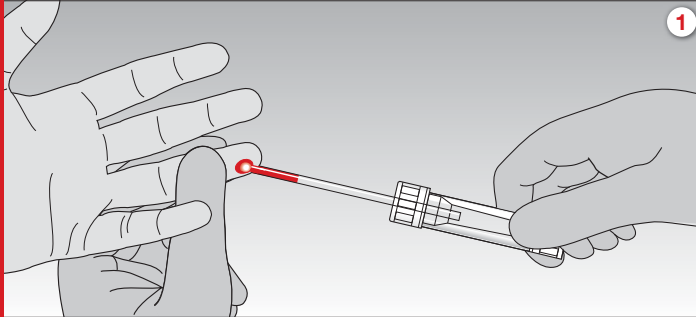

1. Collect blood with the assembled End-to-End 100 µl or 200 µl capillary. For collection, best results are achieved if the Microvette® is held in horizontal or slightly inclined position. During blood collection, hold the capillary 3 to 5 mm away from the puncture site.

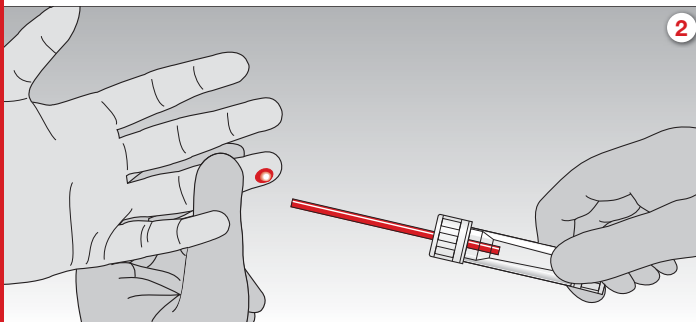

2. Collection is complete when the End-to-End capillary is entirely filled with blood.

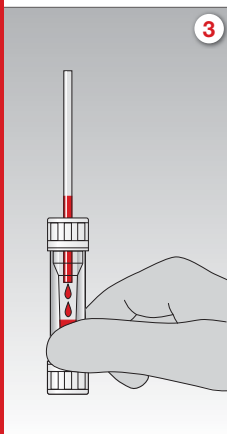

3. Hold the tube upright to allow the blood to flow from the capillary into the Microvette®.

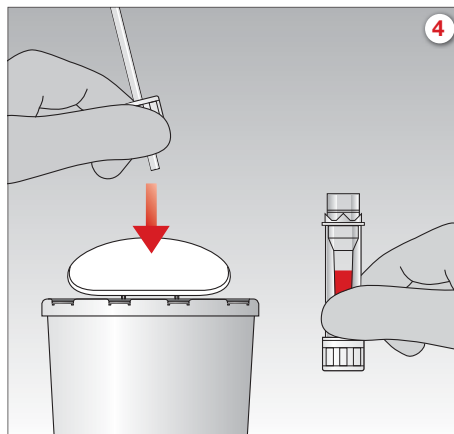

4. Turn the cap to remove and discard the preassembled capillary as one unit.

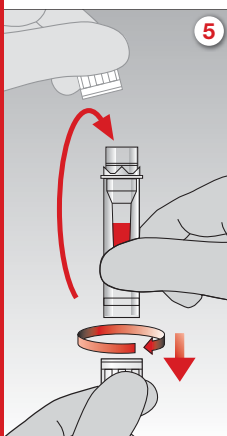

5. Remove the cap from the base and seal the Microvette® ('click' position).

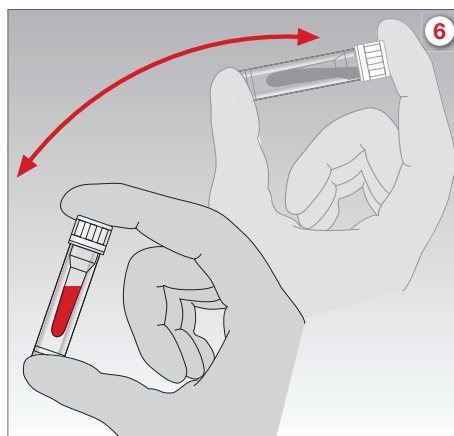

6. Mix sample thoroughly by inverting the Microvette®.

**All patient blood specimens should be treated with standard precautions.**

**Wear gloves!**

# Microvette® 300/500

## User Guide

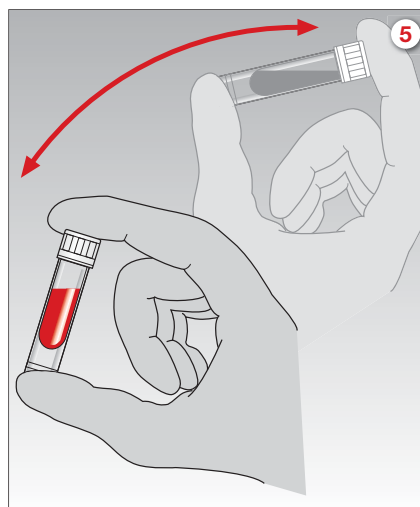
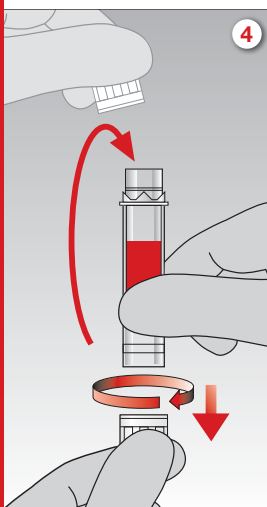
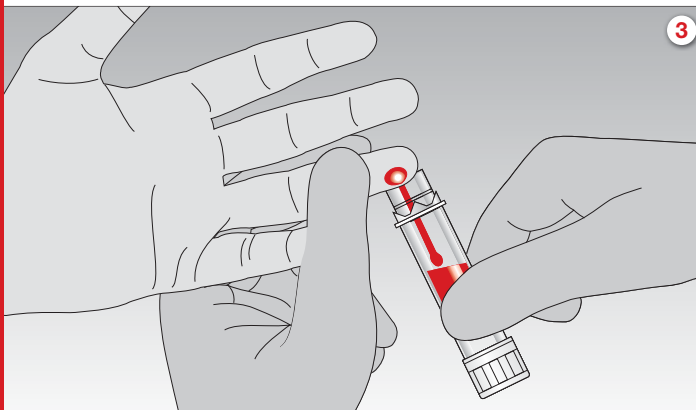
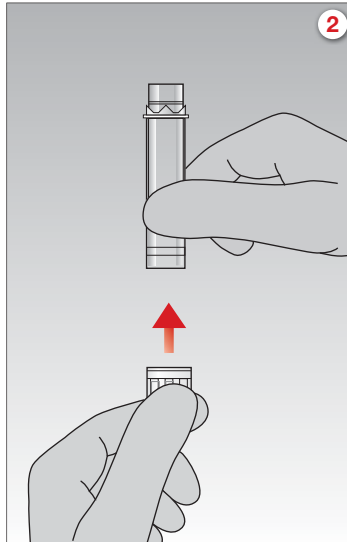
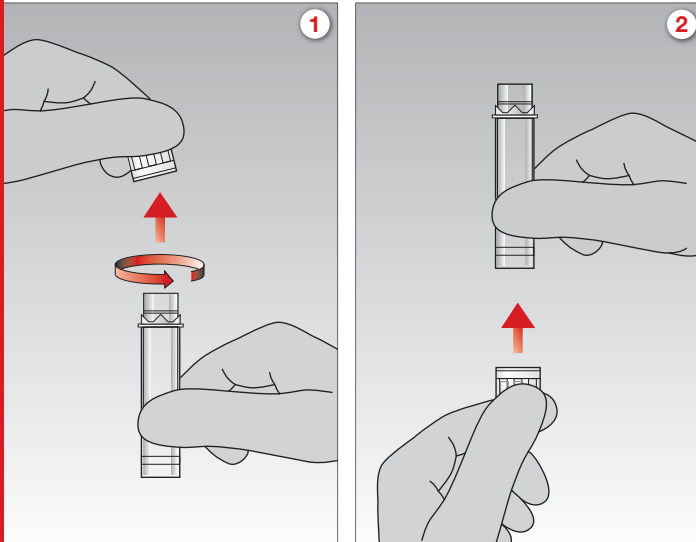

1. Turn the cap to remove it from the Microvette®.

2. Attach the cap to the base of the Microvette®.

3. Collect blood by gravity-flow using any part of the collection rim.

4. Remove the cap from the base and seal the Microvette® ('click' position).

5. Mix sample thoroughly by inverting the Microvette®.

**All patient blood specimens should be treated with standard precautions.**

**Wear gloves!**

Technical modifications reserved

This document may contain information on products that may not be available in particular countries

264d-200

SARSTEDT AG & Co.  
P.O. Box 12 20  
D-51582 Nümbrecht  
Phone +49 2293 305-0  
Fax +49 2293 305-3992  
export@sarstedt.com  
www.sarstedt.com

 **SARSTEDT**