

S-Monovette® POC Collect Kit

Controlled blood sampling and dispensing



Prevent errors
in point-of-care
diagnostics!



SARSTEDT

For ALL venous and arterial POC samples!

S-Monovette® POC Collect Kit

- Reduced need for additional test cartridges
- Simple and controlled dispensing
- Decreased turn-around-time
- Improved patient care
- Maximum safety through closed blood transfer

The S-Monovette® POC Collect Kit is designed for controlled venous/arterial blood collection from vascular access lines and controlled (drop-accurate) sample dispensing to point-of-care test cartridges. After sample delivery, the S-Monovette® can be sent directly to the laboratory if confirmation testing is required; in terms of Patient Blood Management, no additional blood collection is required.

The S-Monovette® POC Collect Kit significantly reduces error susceptibility and offers the end user process reliability.
 - Laboratory manager of a 387-bed clinic



Eliminate or reduce your controllable sources of error:

- Overfilling
- Underfilling
- Air bubbles
- Complicated handling

Three key hospitals conducted a total of 27,630 point-of-care tests. The new S-Monovette® POC Collect Kit reduced the number of controllable errors from an average of 15% to less than 1%. Further, there was not even one overfilled test cartridge, which is the most common error.



Hospital A—Controllable errors lowered to 1.06%

Where	Total number of test cartridges	Time period	Number of test cartridges not measured	Relative proportion of test cartridges not measured
Entire hospital	5,015	7 months	53	1.06%

Hospital B—Controllable errors reduced to 0.95%

Where	Total number of test cartridges	Time period	Number of test cartridges not measured	Relative proportion of test cartridges not measured
Entire hospital	7,976	12 months	76	0.95%

Hospital C—Controllable errors reduced to 0.65%

Where	Total number of test cartridges	Time period	Number of test cartridges not measured	Relative proportion of test cartridges not measured
Entire hospital	14,639	9 months	95	0.65%

Kit components:

- Luer-Lock Multi-Adapter for connection to vascular access lines
- POCT DISPENSER for sample dispensing
- S-Monovette® 1.2 ml lithium heparin for blood collection and sample dispensing

Ordering Information

Order No.	Description	Packaging
51.5100.100	S-Monovette® POC Collect Kit:	1 Kit / Zip bag 50 kits / case



Instructions for use

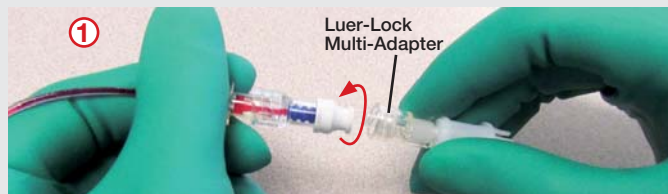

Prepare the vascular access lines according to facility policy. Connect the Luer-Lock Multi-Adapter to the vascular access line.

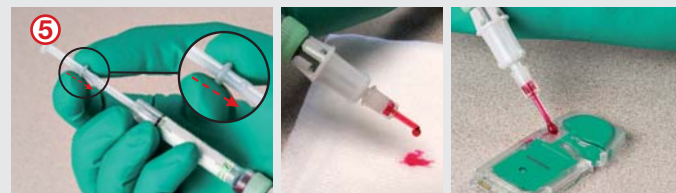
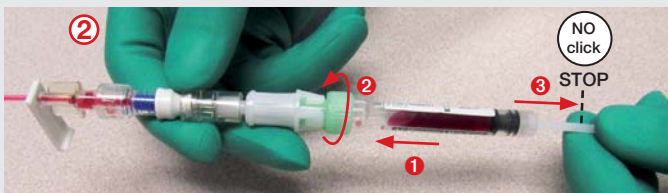
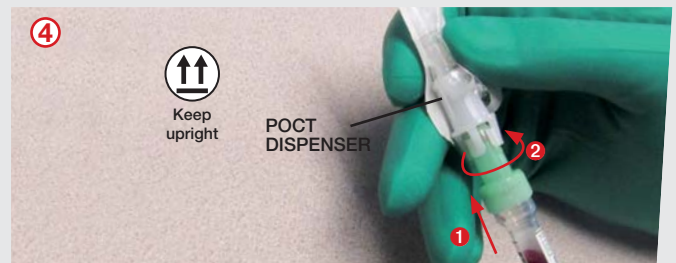

1. Discard the first blood drop(s) according to facility or test requirements.
2. Dispense the sample into the POC test cartridge by gripping the plunger ring and carefully moving the plunger forward



SARSTEDT, Inc.
1025 St. James Church Road
P.O. Box 468
Newton, NC 28658 - 0468
Toll free: +1 800 257 5101
Fax: +1 828 465 4003
customerservice.us@sarstedt.com
www.sarstedt.com